



we  clean

User Guide



Vax Careline 0844 412 8455

Bagless Cylinder *essentials*

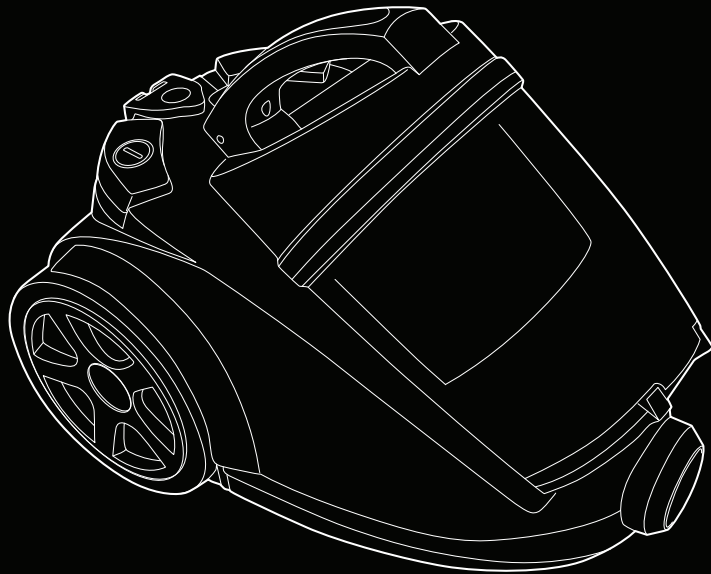

Get Cleaning...

What's your Vax's model number?

V E C - 1 0 - -

What's your serial number? (Located on the base of the machine)

- -

Note these down in case you need them in future. Please keep instructions for further use.

vax.co.uk

VEC-101 / 102

Machine Overview

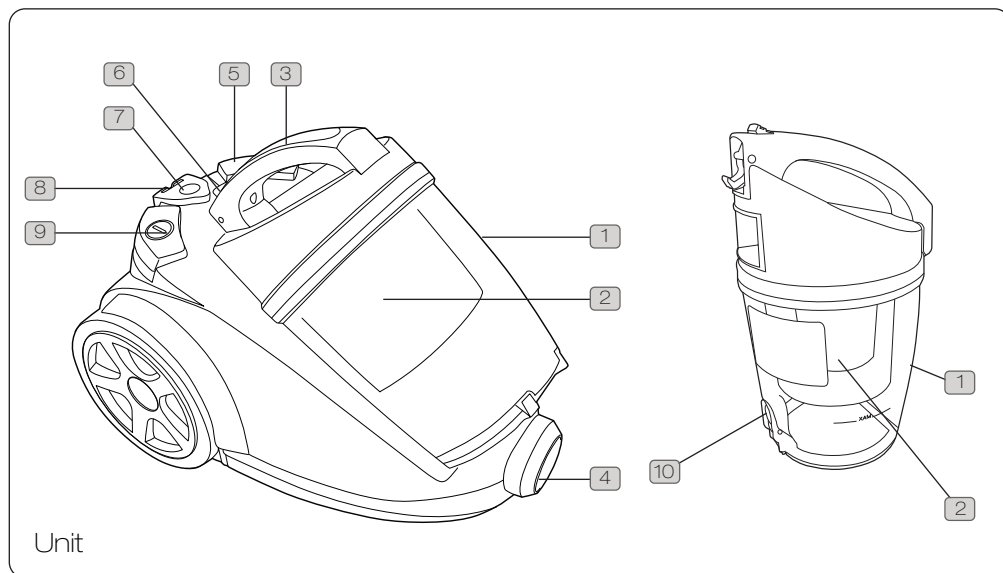

Unit

- | | | | |
|---|---------------------|----|-------------------------------|
| 1 | Dirt container | 6 | Dirt container release button |
| 2 | Central HEPA filter | 7 | Blockage indicator |
| 3 | Carry handle | 8 | Floor tool parking |
| 4 | Hose inlet | 9 | On/off switch |
| 5 | Cord rewind | 10 | Dirt container empty catch |

PLEASE NOTE: some parts may vary according to model. Please check inside flap of box for more details.

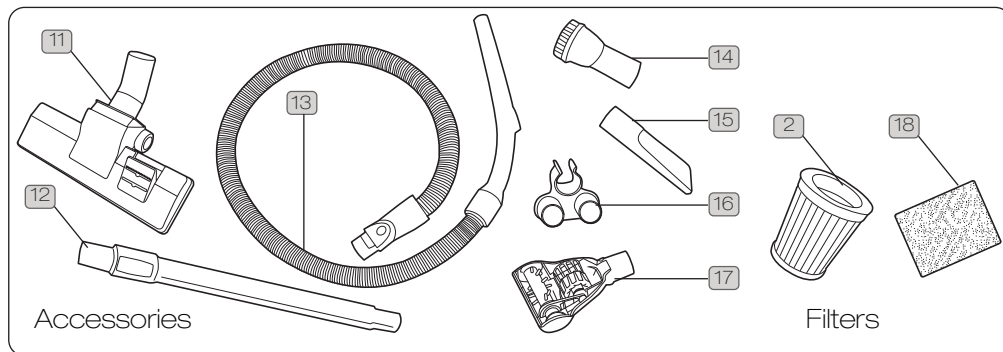

Accessories

Filters

- | | | | |
|----|---------------------------|----|------------------------------|
| 11 | Combination floor head | 15 | Crevice tool |
| 12 | Telescopic extension tube | 16 | Tool storage handle clip |
| 13 | Hose | 17 | TurboTool (some models only) |
| 14 | Dusting brush | 18 | Fibre post-motor filter |

General Safety Information

FOR HOUSEHOLD USE ONLY.

When using the vacuum cleaner, basic safety precautions should always be observed, including the following:

1. Only use the vacuum cleaner indoors on dry surfaces.
2. Turn off the vacuum cleaner controls before disconnecting or connecting from the mains supply.
3. Always unplug the vacuum cleaner before connecting or disconnecting the vacuum hose and accessories.
4. Children should be supervised to ensure that they do not play with the appliance.
5. This appliance is not intended for use by persons (including children) with reduced physical, sensory or mental capabilities, or lack of experience and knowledge, unless they have been given supervision or instruction concerning use of the appliance by a person responsible for their safety.
6. Use only as described in this manual. Use only Vax recommended attachments.
7. Do not use the vacuum cleaner if it has been dropped, damaged, left outdoors or dropped into water. Do not use the vacuum cleaner with a damaged cord or plug. If the supply cord is damaged return the vacuum cleaner to a Vax Authorised Service Agent or contact the Vax Careline on 0844 412 8455 for assistance.
8. Do not pull or carry by cord. Do not use the cord as a handle, close a door on the cord or pull cord around sharp edges or corners. Do not run the vacuum cleaner over the cord. Keep the cord away from heated surfaces.
9. Do not handle the plug or vacuum cleaner with wet hands. Do not use outdoors or on wet surfaces.
10. Do not put any objects into openings. Do not use with any openings blocked and do not restrict airflow. Keep all openings free of dust, lint, hair or anything that might reduce airflow.
11. Keep hair, loose clothing, fingers and all parts of the body away from openings and moving parts.
12. Do not pick up hot coals, cigarette butts, matches or any hot, smoking or burning objects.
13. Do not pick up flammable or combustible materials (lighter fluid, petrol, kerosene etc.) or use in the presence of explosive liquids or vapours.
14. Do not vacuum up harmful or toxic material (chlorine, bleach, ammonia, drain cleaner etc.).
15. Do not vacuum up hard or sharp objects such as glass, nails, screws, coins, etc.
16. Do not use without ALL of the filters in place.
17. Take extra care when vacuuming on stairs.
18. Keep vacuuming area well lit.
19. Store the vacuum cleaner in a cool, dry area.
20. Turn off the on/off switch before unplugging the vacuum cleaner
21. Use only CE-approved 13 amp extension cords. Non-approved cords may overheat. Care should be taken to arrange the cord so that the cord cannot be tripped over.



WARNING: Always switch off and unplug the vacuum cleaner from the electrical outlet before assembling, opening or emptying the dirt container, or before connecting/disconnecting the attachments.



CAUTION: The vacuum cleaner is a very powerful unit. Before plugging the cord into the electrical outlet, make sure the switch is in the 'off' position.



IMPORTANT: If the inlet, hose or telescopic tube is blocked, switch off the vacuum cleaner and remove the blockage(s) before re-starting the vacuum cleaner. See Maintenance: Clearing blockages.



IMPORTANT: Washing filters improves vacuum performance. Vax recommends that they should be checked and cleaned periodically (depending on the level of use). Make sure all filters are completely dry before inserting back into the vacuum cleaner.



IMPORTANT: The motor is equipped with a thermal cut-out. If for any reason the unit should overheat, the thermostat will automatically turn the unit off. Should this occur, unplug the vacuum cleaner from the electrical outlet and turn off the switch. Remove dirt container and empty. Clean filters. Allow the unit to cool for approximately one (1) hour. To re-start, plug into an electrical outlet and switch back on.

This vacuum cleaner is intended for household use only and NOT for commercial or industrial use.

PLEASE KEEP INSTRUCTIONS FOR FURTHER USE.

Operation

Keep your Vax like new

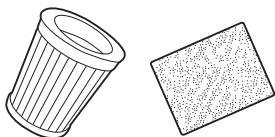

! **IMPORTANT:** The condition of the filters affects the performance of your machine. Please check and wash filters periodically (depending on the level of use). For full cleaning instructions, see page 5.

! **IMPORTANT:** Do not use the vacuum cleaner without all of the filters in place.

Assembling your vacuum cleaner

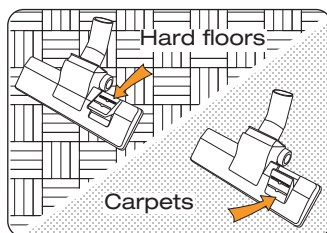
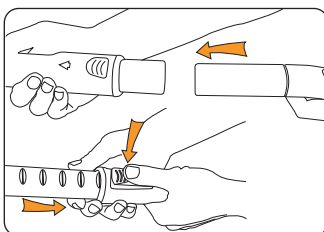
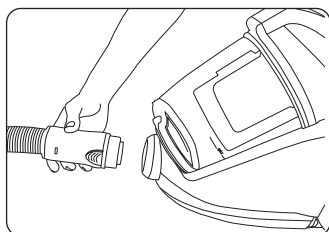

NOTE: The TurboTool, crevice tool and dusting brush can all be attached to the telescopic tube or caddy on the hose handle.

Operating the appliance

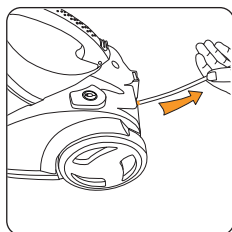

NOTE: Fully extend the power cord before each use. A yellow mark on the cord indicates the recommended cord length. Do not exceed the cord length beyond the yellow mark.

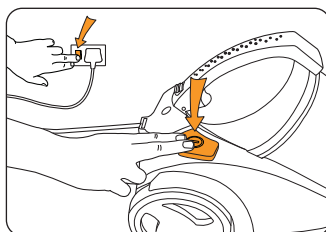

Packing away and storage

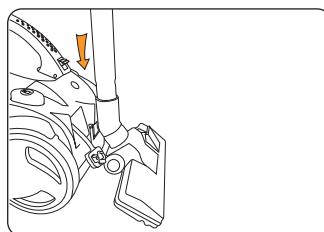
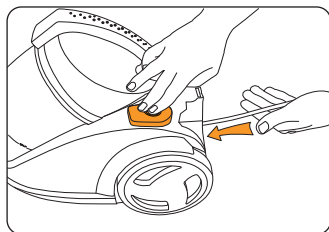

NOTE: For convenience there is a parking slot located at the back of the vacuum cleaner where the floor tool can be attached for storage and carrying.

Maintenance (Keep your Vax as good as new)

Emptying and cleaning the dirt container

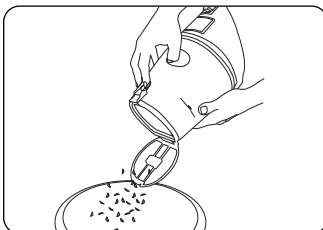
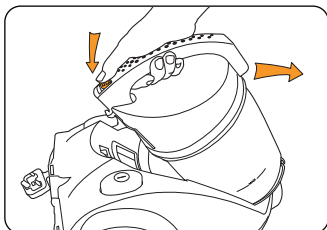

Cleaning the Central HEPA filter

! **IMPORTANT:** Water temperature should be at a maximum of 40° C when washing filters

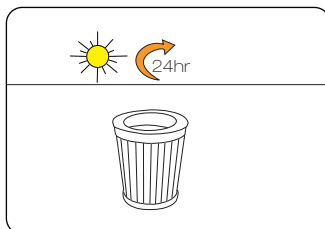
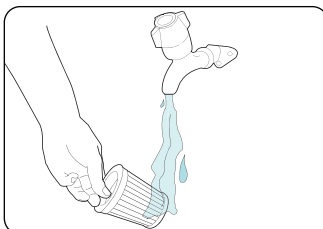
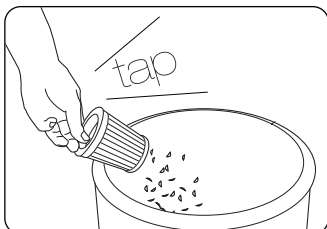
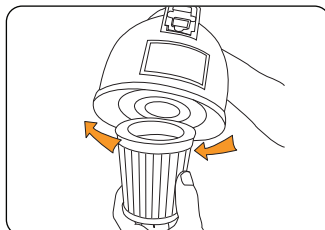
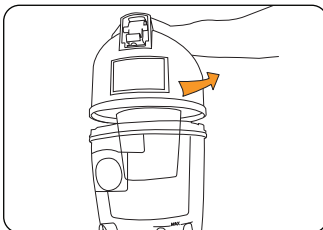
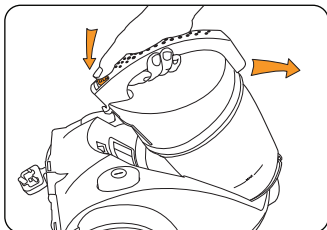

Cleaning the post-motor filter

! **IMPORTANT:** Water temperature should be at a maximum of 40° C when washing filters

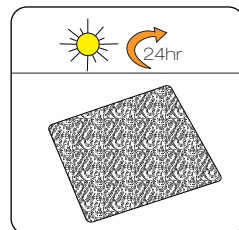
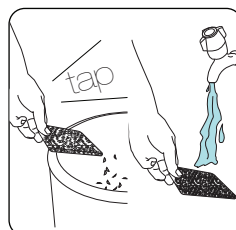
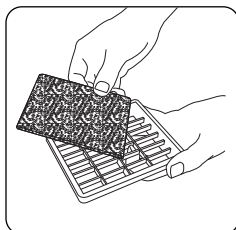
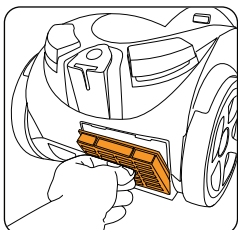

Maintenance (Keep your Vax as good as new)

Clearing blockages

Warning: To reduce the risk of electric shock, the power cord must be disconnected from the mains supply before performing maintenance/troubleshooting checks. Turn the vacuum cleaner off and unplug from the electrical socket

Hose blockages

The flexible hose should be disconnected from the vacuum cleaner. Carefully remove any blockages found and reconnect the hose securely.

Accessory blockages

Remove accessory from the hose/handle tube. Carefully remove the blockage and return to the cleaner.

Clearing debris from the TurboTool (some models only)

NOTE: Switch the cleaner off and disconnect the power plug from the electrical outlet before performing this check.

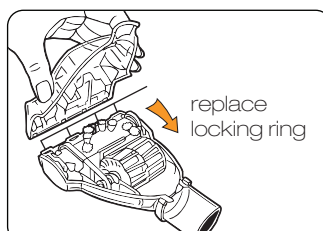
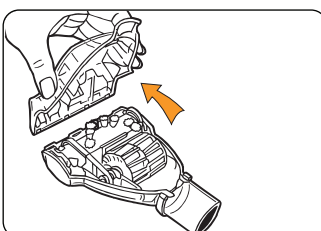
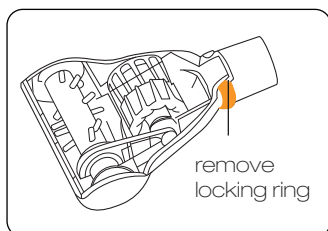

Using a pair of scissors, cut through any threads or hairs caught around the TurboTool brushbar.

This page has been left intentionally blank

FAQs



WARNING: to reduce the risk of personal injury, unplug the vacuum cleaner before performing maintenance/troubleshooting checks.

Is there an accessory missing?

- Check the 'Parts Overview' page in this guide to make sure the part is definitely included in your unit.
- If it is missing, we're here to help. Simply call us on **0844 412 8455**

Why won't the vacuum cleaner pick up?

- The dirt container may be incorrectly installed; remove the dirt container from the unit by pressing the dirt container release button [6] and then re-attaching it to the unit, ensuring it is locked firmly back into place.
- The filter may be clogged; refer to 'Maintenance: Cleaning the filters' on page 5.
- The dirt container may be blocked; refer to 'Maintenance: Emptying and cleaning the dirt container' on page 5.

Why is dust escaping from the vacuum?

- The filter may be clogged; refer to 'Maintenance: Cleaning the filters' on page 5.
- The dirt container may be blocked; refer to 'Maintenance: Emptying and cleaning the dirt container' on page 5.
- The dirt container may be incorrectly installed; remove the dirt container from the unit by pressing the dirt container release button [6] and then re-attaching it to the unit, ensuring it is locked firmly back into place.

What do I do if the unit/an accessory becomes damaged or broken?

- We're here to help. Simply call **0844 412 8455** or visit vax.co.uk

Why won't the accessories pick up properly?

Hose blockages: remove the flexible hose from the unit. Carefully remove any blockages found and reconnect hose securely.

Accessory blockages: remove accessory from handle/tube. Carefully remove blockage and re-attach to the vacuum cleaner.

- The accessory may be faulty. Simply call us on **0844 412 8455** for assistance.

Why will the vacuum cleaner not run?

- It may not be plugged into the electrical outlet correctly; ensure that the plug is pushed in securely.
- The electrical outlet may not be working properly; check the fuse or breaker, or consult an electrician.
- The motor thermostat may have tripped; switch off and unplug the vacuum cleaner, and leave for one hour before switching the cleaner back on.



we  to help

Don't take your machine back to the shop, simply contact us

vax.co.uk

0844 412 8455

This does not affect your statutory rights.

Other Information

UK Service & Help

Vax Customer Careline 0844 412 8455

Monday-Friday 8.30am to 6.30pm

Saturday-Sunday 9.00am to 5.00pm

Any queries or concerns about using the Vax, call the Vax Careline.

Please make a note of the serial number and model number of the carpet cleaner before calling.

Technical Specification

Voltage:	220-240V ~50Hz
Wattage:	2000 W
Capacity:	2.6L
Filters:	Central HEPA filter (washable) Fibre post-motor filter (washable)
Cord length:	5 m (approx)
Weight:	5.2kg

Subject to technical change without notice.



EEC Statement of Compliance

Manufacturer/EEC importer: Vax Limited, hereby on our own responsibility, declare that the VEC-101 / 102 Essentials Series is manufactured in compliance with the following Directives:

Safety: 2006/95/EC Low Voltage Directive

EMC: 2004/108/EC Electromagnetic Compatibility Directive



Waste electrical products should not be disposed of with household waste. Please recycle where facilities exist. Check with your Local Authority or retailer for recycling advice.



we  clean

Vax Ltd., Kingswood Road, Hampton Lovett, Droitwich, Worcestershire, WR9 0QH, UK
email: info@vax.co.uk - website: vax.co.uk